

LASERLYTE

Printed on recycled paper

LASERLYTE®

KRYPTONYTE® CENTER MASS™ LASER

- Laser projects a ring of 9 dots
- Quicker target acquisition than just one dot
- 5mw, Green Laser power at 532nm
- Fits Picatinny rails, 3" or longer
- Made from 6061 T6 Aluminum

Laser beam projection

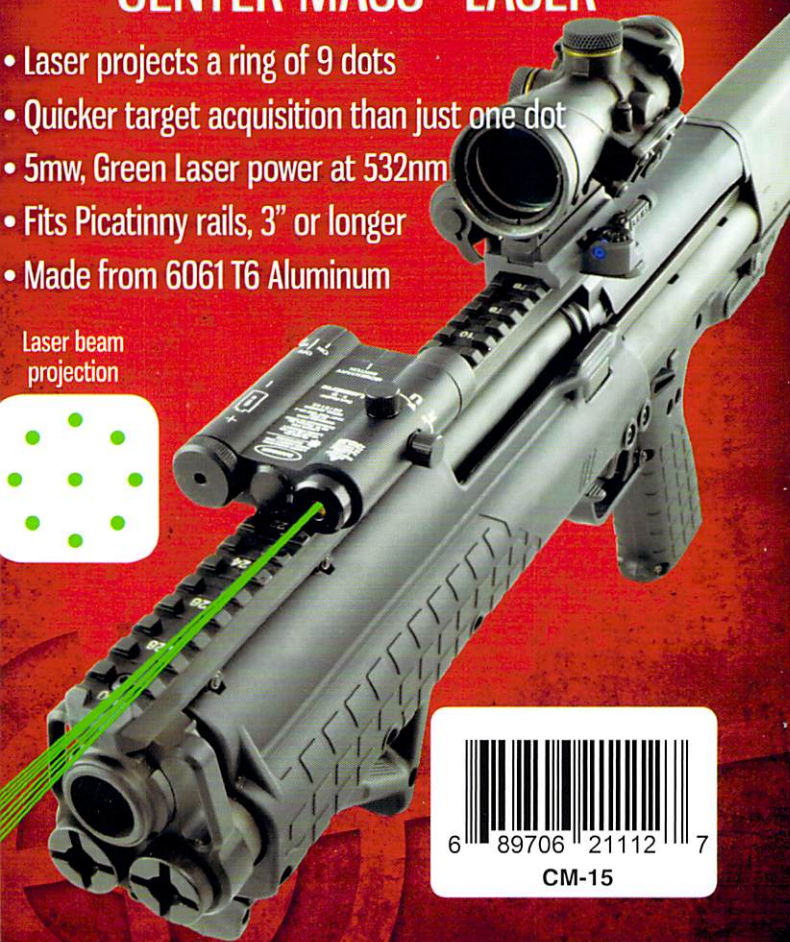
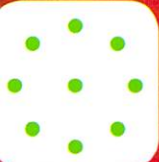

LASERLYTE

KRYPTONYTE® CENTER MASS™ LASER

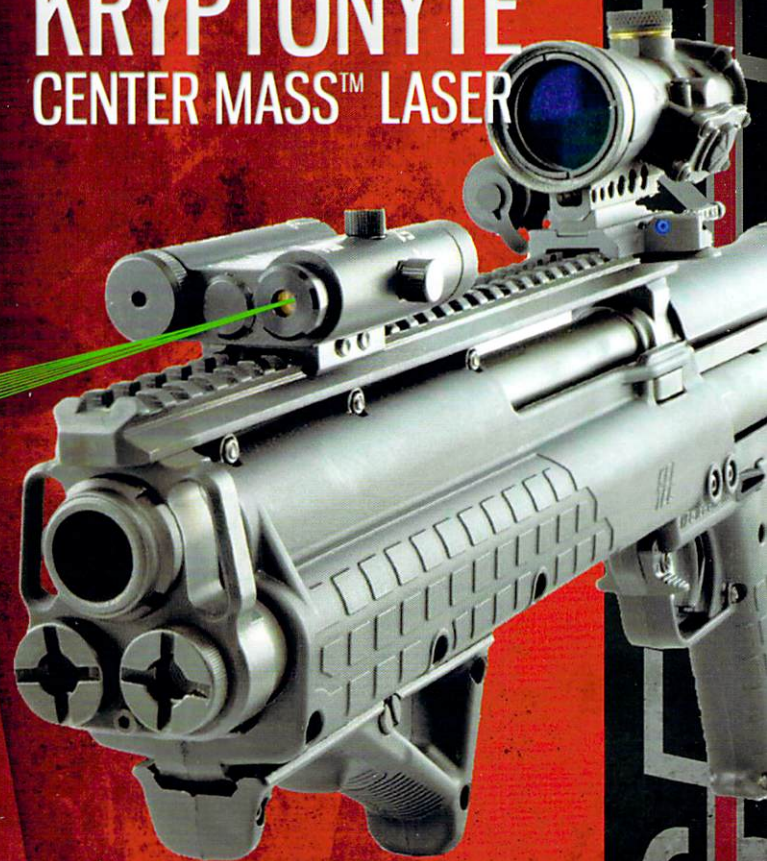

CM-15

LASERLYTE®

www.LASERLYTE.com

CE
RoHS

REV0712

KRYPTONYTE® CENTER MASS™ LASER

CM-15

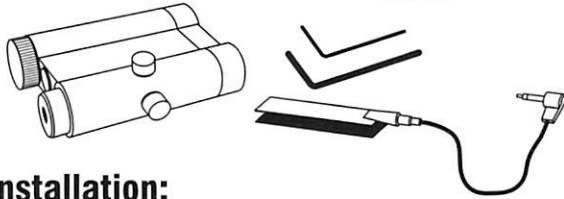

Installation:

- 1 UNLOAD YOUR FIREARM!
- 2 Place the CM-15 on to the picatinny rail.
- 3 Align the clamp screws with the spaces in the rails.
- 4 Use the provided Allen wrench and tighten the clamp to the rail.
- 5 Mount the remote switch to the desired location with the provided Velcro® strips.

1 UNLOAD YOUR FIREARM!

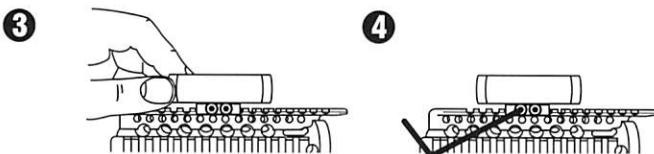
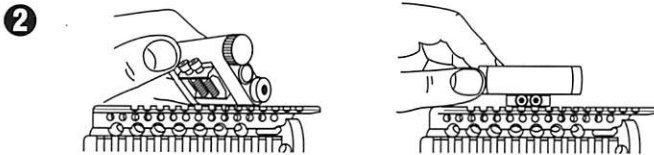

Mount the remote switch to the desired location with the provided Velcro® strips.

Sighting In:

- 1 Locate the turret caps and remove them.
- 2 Using the provided Allen wrench adjust the laser until it corresponds with your sights.
- 3 ALWAYS SIGHT-IN CENTER DOT TO POINT OF IMPACT.
- 4 Always end in a clock-wise motion. Re-install caps.
- 5 Make final adjustments at the range.

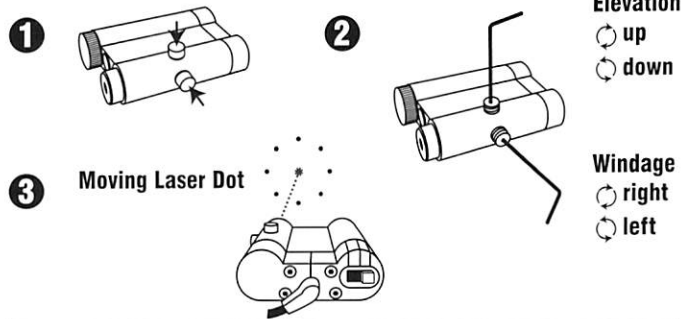

Activation:

- 1 Locate the three position switch at back of the laser.
- 2 Left is constant on - center is off - right is momentary switch.
- 3 Momentary Switch:
 - a. Insert the plug connected to switch into the back of the laser.
 - b. Select the momentary switch setting.
 - c. Apply pressure to pad to turn laser on, release pressure on the pad to turn laser off.

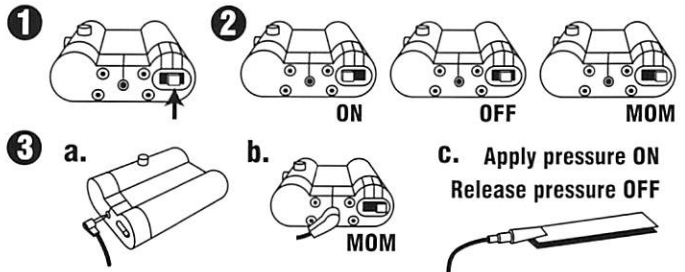

Battery Installation: (1) CR123

- 1 Locate the battery cap and unscrew from body.
- 2 Remove battery
- 3 Insert new battery
- 4 Screw in battery cap and tighten.

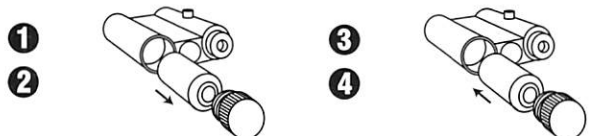

WARRANTY:
Three Year Limited
Warranty.



LASERLYTE®
30 N. Alamos Drive - Cottonwood, AZ 86326
Phone 928-649-3201 • Fax 928-649-3970
www.LaserLyte.com