



SUBCOMPACT V3

- Mounts on any standard rail
- No Gunsmithing required
- Dual Laser Modes
- Auto-Off Feature
- Full 5mw power



SUBCOMPACT V3



FSL-3



www.LASERLYTE.com



REV0812

Reset Process:

- 1 Back-out both adjustment screws.
- 2 Let laser sit for 10 minutes at room temperature (68°F/20°C).
- 3 If, within 20 minutes, the laser is not pointing up and left call customer service.



Battery Installation: (4) 377

- 1 Unscrew battery cap and remove batteries.
- 2 Install new batteries with positive facing the cap and screw in battery cap and tighten.



WARRANTY:
Three Year Limited
Warranty.



30 N. Alamos Dr. - Cottonwood, AZ 86326
Phone 928-649-3201 - Fax 928-649-3970
www.LaserLyte.com

V3 Sub Compact Rail Mount Laser

FSL-3

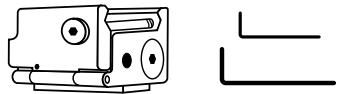

Installation:

1 UNLOAD YOUR FIREARM!

- 2 A. Loosen the clamp screw/cross bar.
B. Align clamp screw/cross bar with cross cut on rail.
C. Press the laser onto the rail.

3 Tighten the clamp screw/cross bar until snug.

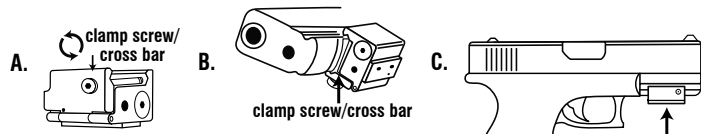

Laser Sight In:

Assemble weapon and make safe.

- 1 Align front and rear sights by shining laser dot 21 ft. (recommended) away in a safe direction.
- 2 First! Use windage screw to adjust laser dot .5 inch to the left of front sight.
- 3 Second! Use elevation screw to adjust laser dot .5 inch above front sight.
- 4 Third! Use both screws in 1/4 turn increments to move dot above front sight.
- 5 Make final adjustments at shooting range. (Always end adjustments on a clockwise turn.)

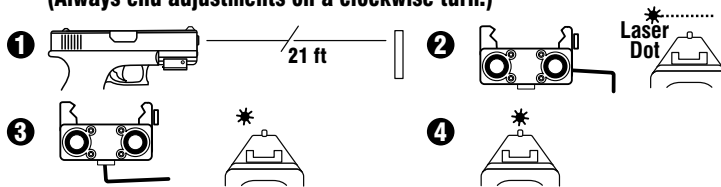

Activation:

- 1 Press either of the black buttons once to activate laser: constant or pulse.
- 2 Press and hold for 5 seconds to change mode.
- 3 Second press turns laser off.

1

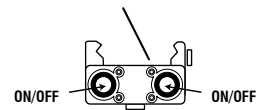

2

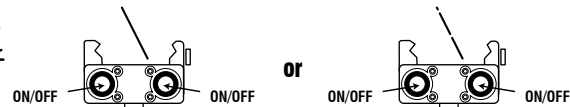

3

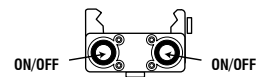

Auto-Off feature:

- After 5 minutes a warning pulse will activate.
- After 1 minute in warning pulse mode, laser will turn off.
- Press the switch during warning pulse for laser reset.

