

Laser for North American Arms® Black Widow & Mini Master

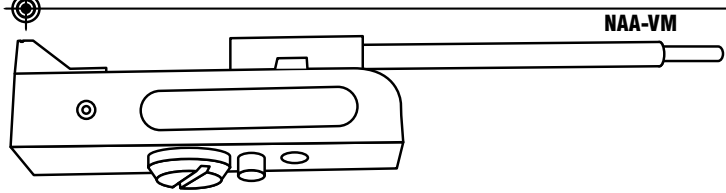

* **Read instructions completely before installing your laser.**
Failure to do so may result in damage to your laser or firearm.
Installation:

- **UNLOAD FIREARM.**
 - **Attach danger label to side of gun near laser with arrow pointing toward front sight.**
 - **DO NOT TOUCH THESE SCREWS (Figure A).**
- 1 **While pointing firearm in safe direction place cylinder back into gun.**
 - 2 **Turn laser block 90 degrees to cylinder pin and slide into cylinder pin groove.**
 - 3 **Once fully seated in cylinder pull down on laser body and turn towards muzzle locking laser in place.**
 - 4 **When properly installed laser should not turn to sides.**

- **UNLOAD FIREARM.**
- **Attach danger label to side of gun near laser with arrow pointing toward front sight.**
- **DO NOT TOUCH THESE SCREWS.**

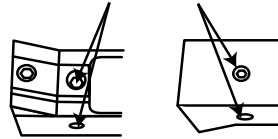

(Figure A)

1

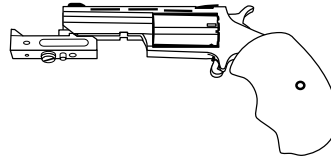

2

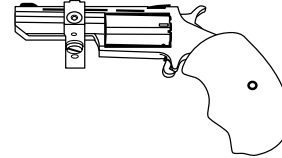

To fit the Mini Master, remove this screw and triangle block



(Figure B)

3

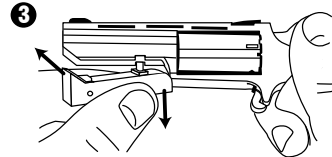

4

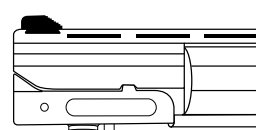

Activation: laser has ambidextrous activation.

- 1 **Press once turns laser on: constant or pulse.**
- 2 **Press and hold for 5 seconds to change mode.**
- 3 **Second press turns laser off.**

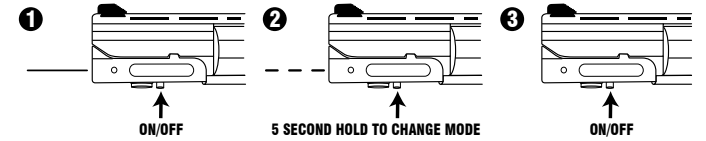

Auto-Off Feature:

- **After 5 minutes in any mode, warning mode pulse will activate.**
- **After 1 minute in warning pulse mode, laser will turn off.**
- **Press the switch during warning pulse for laser reset.**

