



# REAR SIGHT LASER - RUGER® P-SERIES

## REAR SIGHT LASER

- Fits Ruger® P85, P89, P90, P91, P93, P94, P95 and P97
- Replaces factory rear sight
- Includes all hardware for installation
- Fits virtually all holsters
- Dual laser modes with LED emissions indicator



RL-RP



[www.LASERLYTE.com](http://www.LASERLYTE.com)



REV0518

### Uninstall:

- 1 Follow steps 1-3 in Installation Instructions.
- 2 Back out setscrew in center of Laser.
- 3 Using brass punch put the narrow end of the punch on the flat surface of the laser dove tail.
- 4 Using a small hammer drive the laser out from right to left.
- 5 Back out laser setscrews until flush.
- 6 Wait 15 minutes for adjustment reset and reinstall if desired.

### Battery Installation: (4) 377

- 1 Unscrew battery cap and remove batteries.
- 2 Install new batteries.
- 3 Screw in battery cap and tighten.

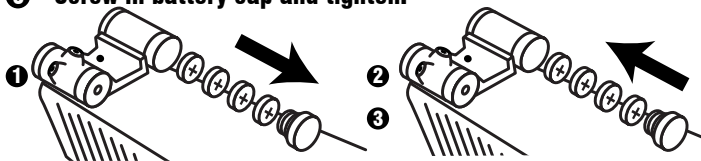

**WARRANTY:**  
One Year Limited  
Warranty.



A Division of P&L Industries  
101 Airpark Road - Cottonwood, AZ 86326  
Phone 928-649-3201 - Fax 928-649-3970  
[www.LaserLyte.com](http://www.LaserLyte.com)

**Rear Sight Laser  
for all Ruger® P-Series**

RL-RP

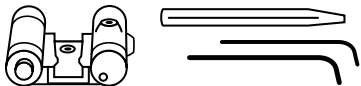

**Installation:**

- 1 UNLOAD YOUR FIREARM!**  
**WARNING: FAILURE TO PROPERLY FOLLOW INSTRUCTIONS MAY DAMAGE FIRING PIN BLOCK PLUNGER (Ruger Part # KH05100)**
- 2 Attach danger label to slide of gun near laser with arrow pointing toward front sight.**
- 3 Remove slide from frame, then remove spring and barrel.**
- 4 Remove rear sight from slide.**
- 5 With laser facing toward the front, start the installation on the LEFT side of the slide drifting it to the right until you reach the Firing Pin Block Plunger. Using the provided punch, depress the plunger and continue drifting the laser to the right and over the plunger.**
- 6 Using a small hammer, align the brass punch to the side of dovetail, tap the punch until laser is centered in slide.**
- 7 Using the included .050 Allen wrench, tighten locking screw in the center of the laser.**

**1 UNLOAD YOUR FIREARM!**

- 2 Attach danger label to slide of gun near laser with arrow pointing toward front sight.**

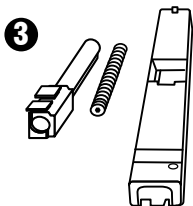

**4**

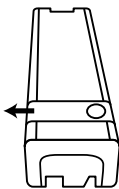

**5**

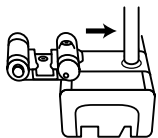

**6**

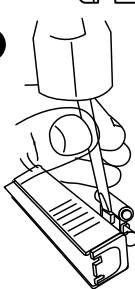

yes

no

no



yes

no

no

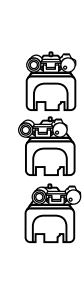

**7**

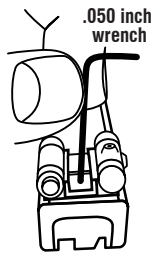

**Activation:**

- 1 Push button once and the laser will be on constant mode.**
- 2 Push button twice and the laser will be on pulse mode.**
- 3 Push button three times the laser will turn off.**
- 4 The small L.E.D. on the back will indicate what mode you are in.**

**1**

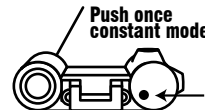

**2**

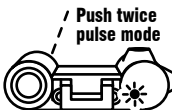

**3**

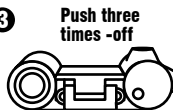

**Laser Sight In:**

- 1 Assemble barrel and spring into slide and then install back onto gun.**
- 2 Make sure your firearm is unloaded and always point in a safe direction.**
- 3 Use the provided .035 Allen wrench to adjust the sight.**
- 4 Always end adjustments on a clockwise turn.**
- 5 Make final adjustments at shooting range.**

**3**

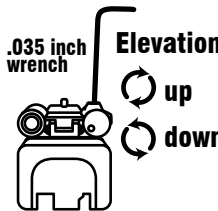

**Elevation**



**Windage**



**Moving Laser Dot**

